

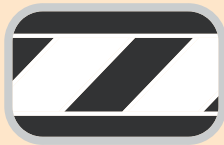

General Trading Limited Liability Company

STOP/PASS

Electromechanical barrier



BARRIERS



Simple internal unlocking system.



Built-in limit-switch on 230V ac models.

accessories PASS

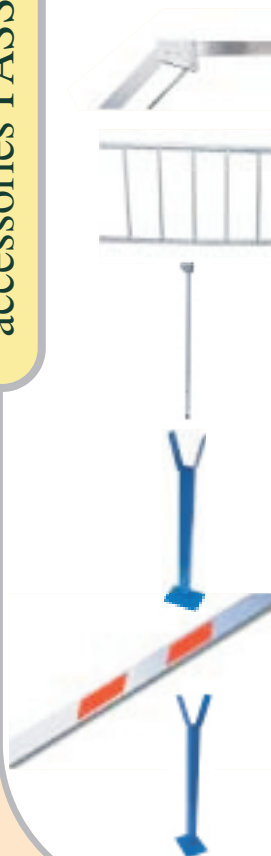

Art. 1004
Folding bar joint.

Art. 1005
Aluminium skirt.

Art. 1006
Mobile support.

Art. 1007
Fixed support.

Art. 1008 PASS
Rectangular boom
cm 300 x 3 x 10

Art. 1010
Adjustable fixed support.

accessories STOP

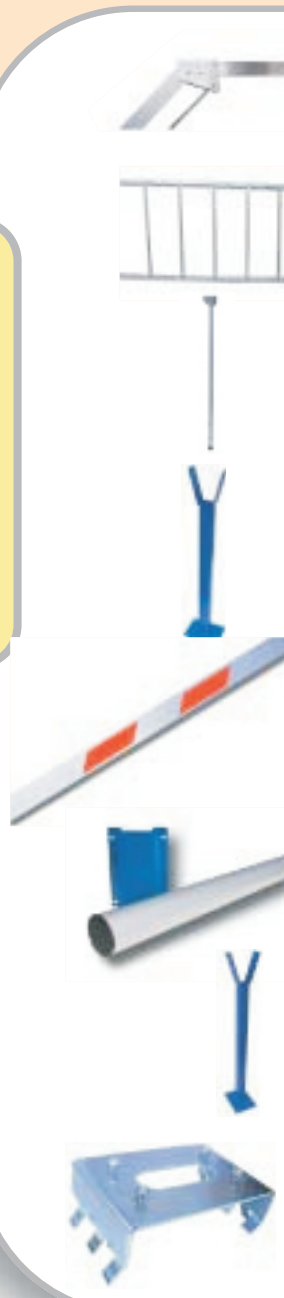

Art. 1004
Folding bar joint.

Art. 1005
Aluminium skirt.

Art. 1006
Mobile support.

Art. 1007
Fixed support.

Art. 1008
Rectangular boom
cm 400 x 3 x 10.

Art. 1009
Rectangular boom
cm 600 x 5 x 10.

Art. 1008T
Round boom 4 mt.

Art. 1009T
Round boom 6 mt.

Art. 1010
Adjustable fixed support.

Art. 1011
Foundation plate.



General Trading Limited Liability Company

Sharja Airport Free Zone, P.O. Box 120679, Sharja
Tel: + 971 50 694 6139 Tele/Fax: + 971 4 355 2833
www.premnet-fzc.com info@premnet-fzc.com

Electromechanical barrier

PASS

RELIABLE AND FAST

PASS is the 3 mt barrier of DEA System which assures a **top reliability**, thanks to the careful research on details.

Ideal for **residential uses** or on small parkings, **PASS** is also available in low voltage, to become so an excellent solution for frequent operations too.



RANGE PASS

- ✧ Electromechanical barrier, 230V ac and 24V dc.
- ✧ Suitable for booms up to 3 mt.
- ✧ Single model for left or right side opening.
- ✧ Painted or stainless steel box complete of door with lock.
- ✧ Simple internal unlocking system.
- ✧ Spring damping.
- ✧ Built-in mechanical limit-switch.
- ✧ Residential or heavy duty (24V dc).
- ✧ Built-in control board.
- ✧ Grease soaked gear motor.

The models

For booms up to 3 mt

PASS 220: barrier 230V ac, built-in control board 203 with reverse on obstacle.

PASS 24: barrier 24V dc, built-in control board 24/400/1 with programmable limit switches and slow-down.

All PASS barriers are also available with stainless steel box.



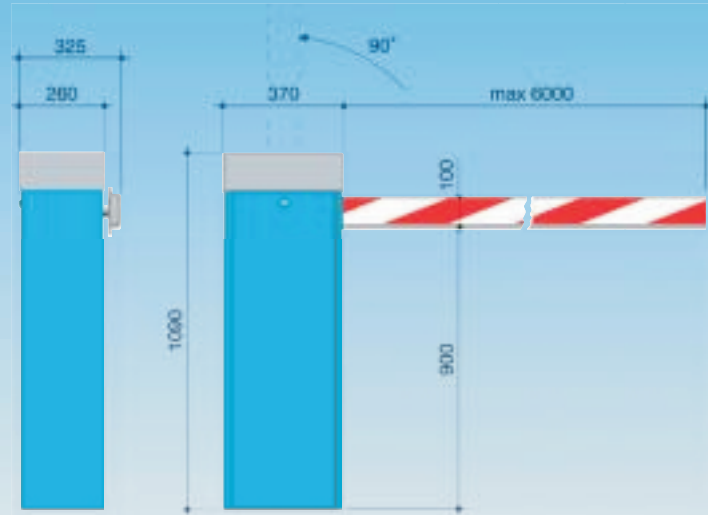
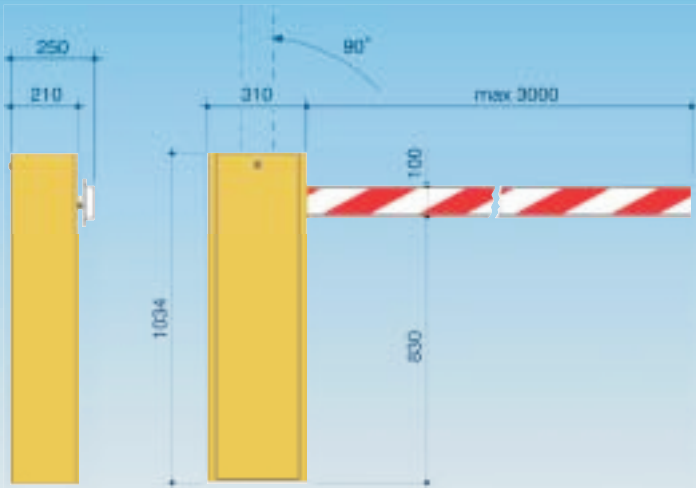

Technical information

Model	PASS 220	PASS/24
Power supply (V) (50/60 Hz)	230 AC	230 AC
Motor power supply (V)	230 AC	24 DC
Capacity (W)	320	120
Condenser incorporated (uF)	8	-
Protection level (IP)	44	44
Operating temperature (°C)	-20 ÷ +60	-20 ÷ +60
Motor thermal protection (°C)	140	-
Duty cycle (%)	40	70
Opening time (sec. 90°)	3,5	3
Weight with packing (kg)	42	41

Technical information

Model	1000	1000/24	1001	1001/24
Power supply (V) (50/60 Hz)	230 AC	230 AC	230 AC	230 AC
Motor power supply (V)	230 AC	24 DC	230 AC	24 DC
Capacity (W)	500	120	500	120
Condenser incorporated (uF)	18	-	18	-
Protection level (IP)	44	44	44	44
Operating temperature (°C)	-25 ÷ +60	-25 ÷ +60	-25 ÷ +60	-25 ÷ +60
Motor thermal protection (°C)	150	-	150	-
Duty cycle (%)	80	80	80	80
Opening time (sec. 90°)	4,5	4	9	7
Weight with packing (kg)	76	75	76	75

Electromechanical barrier

STOP

GREAT STURDINESS AND RELIABILITY

STOP is the barrier of DEA System for the **top safety and strenght.**

Excellent materials and precision on details allow **STOP** to be the ideal solution for parking systems or transit zones at **high use.**

The boom block, equipped of three levers, protects the motor against vandal actions.

STOP is available for booms up to 4 mt or 6 mt.



RANGE STOP

The models

For booms up to 4 mt

STOP 1000: barrier 230V ac, built-in control board 203 with reverse on obstacle.

STOP 1000/24: barrier 24V dc, built-in control board 24/400/1 with programmable limit switches and slow-down.

For booms up to 6 mt

STOP 1001: barrier 230V ac, built-in control board 203 with reverse on obstacle.

STOP 1001/24: barrier 24V dc, built-in control board 24/400/1 with programmable limit switches and slow-down.

All STOP barriers are also available with stainless steel box.

- ✦ Electromechanical barrier, 230V ac and 24V dc.
- ✦ Suitable for booms up to 4 mt or 6 mt.
- ✦ Single model for left or right side opening.
- ✦ Painted or stainless steel box complete of door with lock.
- ✦ Simple internal unlocking system.
- ✦ Spring damping.
- ✦ Built-in limit-switch (on 230V ac models).
- ✦ Semi-heavy duty or heavy duty (24V dc).
- ✦ Built-in control board.
- ✦ Grease soaked gear motor.

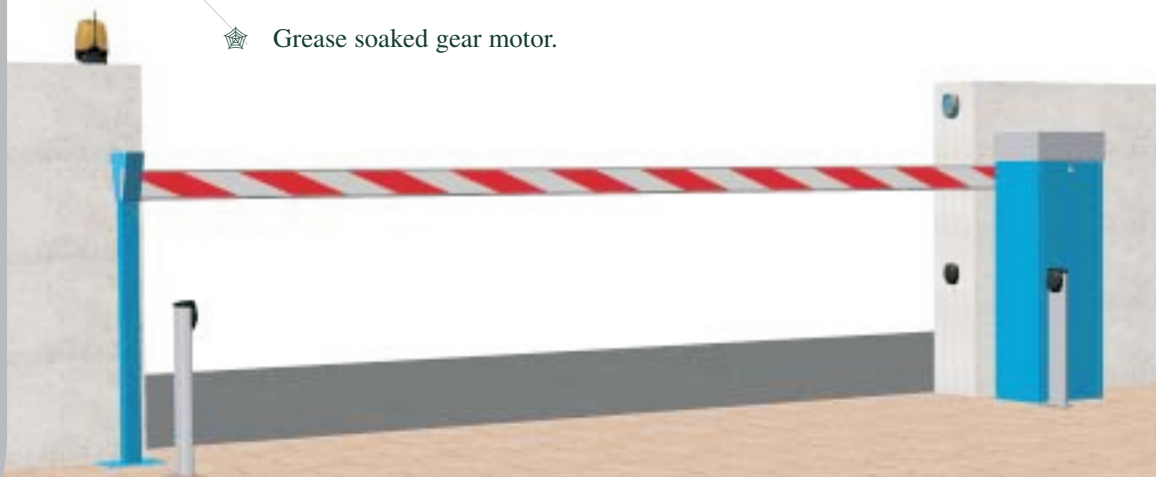

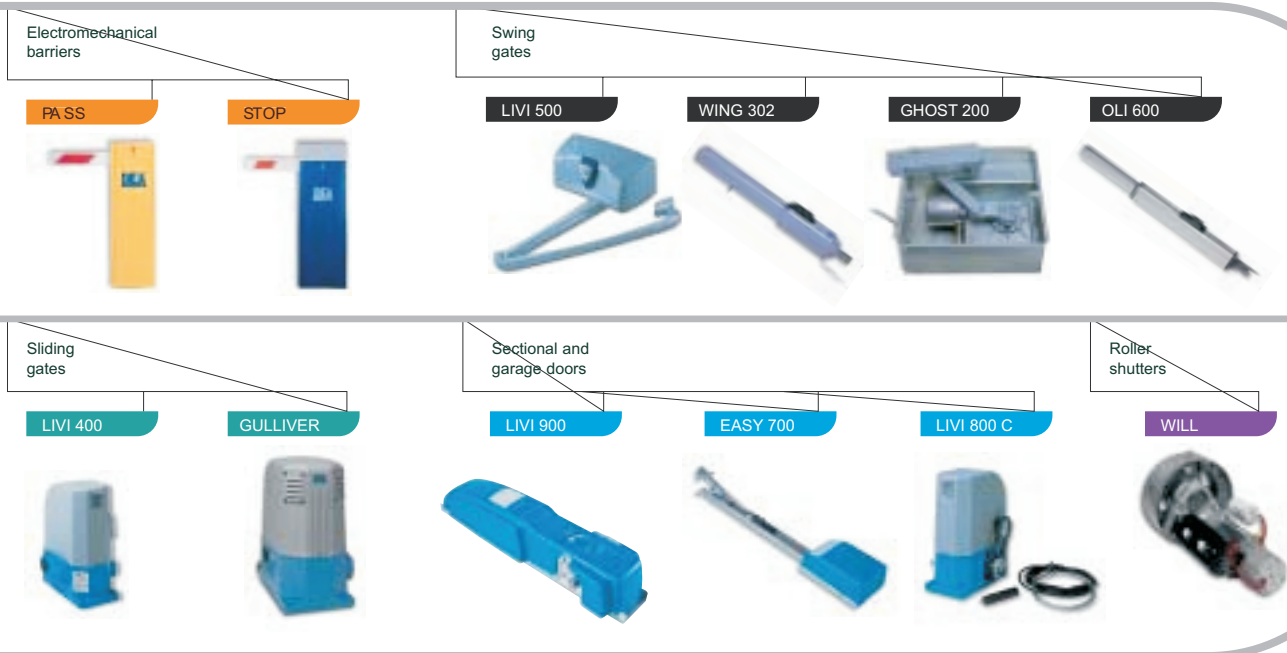

The accessories



Digikey:
Safe and reliable,
available wireless
and hard-wired.



Radio devices:
frequency 433,92 Mhz,
available Dip-Switch
or Self-Learning type.



Flashing light
with built-in
433,92 Mhz
aerial.



Control boards:
230V ac and 24V dc,
safe and simple
to program.



Safety beams:
reliable and easy
to install.



Keyswitch:
available flush mounted or
surface mounted.